

REVISIONS				
ZONE	REV	DESCRIPTION	DATE	APPROVED

F = FLANGE TYPES
 -6 = UG-COVER
 -7 = UG-CHOKE
 -8 = UG-COVER/GROOVE

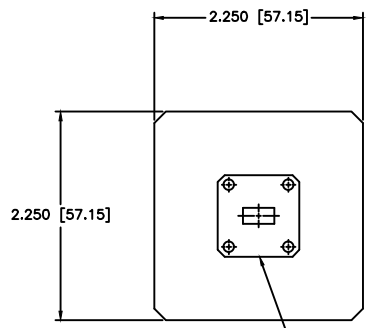

WR34 FLANGE PER ORDER
 UG-COVER STANDARD

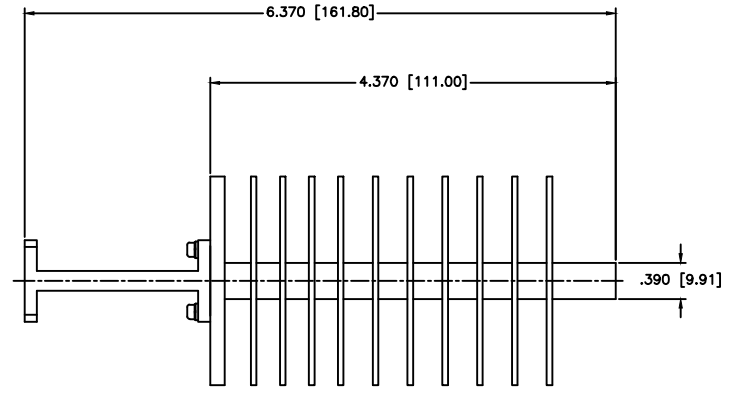

ORDERING INFORMATION
 EXAMPLE PART NUMBER: WL-17-F
 VERY HIGH POWER SERIES
 FREQUENCY BAND
 FLANGE TYPE

SPECIFICATIONS

Frequency Range: 22-33 GHz
 Waveguide Size: WR34 (Input)
 Flange Types: Per Order (-6,-7,-8)
 VSWR: 1.15 Max.
 Average Power: 500 Watts

MATERIAL: ALUMINUM 6061		MICROWAVE COMMUNICATIONS LABORATORIES INC. 7225 30TH AVE. N. SAINT PETERSBURG, FL 33710 TEL: (727) 344-8254 FAX: (727) 381-8118 http://www.mcli.com		SCALE: N/A
DRAWING: Paiboon Luekhamhan		DATE: 05-02-2011	DRAWING TITLE: TERMINATION, WR34 700 Watts	
APPROVED: T. Nguyen		DATE: 05-02-2011	PART NO.: WL-17-F	
UNLESS OTHERWISE SPECIFIED: TOLERANCES IN (INCHES) OR (mm) (MILLIMETERS) FRACTIONS: ± 1/64 DECIMALS: ±.01 ±.005 ANGLE: ±1/2°		CAGE CODE: OD2L5		SIZE: C
<small>CONFORMING TO THE SPECIFICATIONS OF THE DRAWING IS THE PROPERTY OF MCLI AND SHALL BE KEPT IN CONFIDENTIALITY. NO PARTS SHALL BE REPRODUCED OR TRANSMITTED IN ANY FORM OR BY ANY MEANS, ELECTRONIC OR MECHANICAL, INCLUDING PHOTOCOPYING, RECORDING, OR BY ANY INFORMATION STORAGE AND RETRIEVAL SYSTEM.</small>		<small>DO NOT SCALE THE DRAWING</small>		DWG NO.: 85647