

F = FLANGE TYPES

- 1 = CPRG
- 2 = CPRF
- 6 = UG-COVER
- 7 = UG-CHOKE
- S = SPECIAL

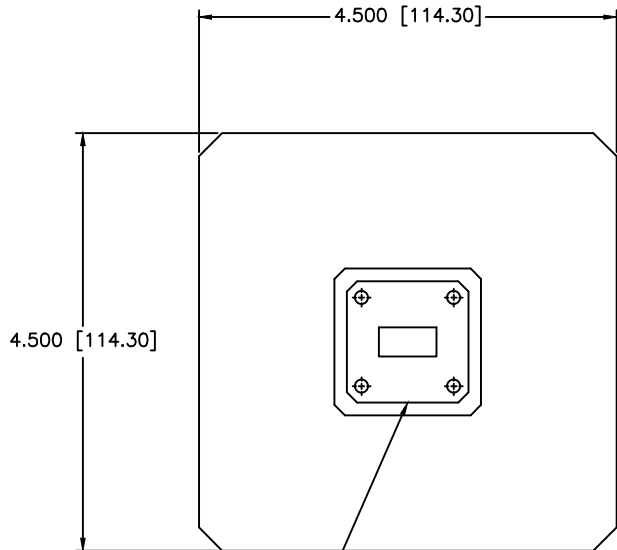

WR62 UG- COVER SHOWN  
FLANGE TYPE PER ORDER

SPECIFICATIONS

Frequency Range: 12.4-18 GHz  
 Waveguide Size: WR62 (Input)  
 Flange Types: Per Order (-1,-2,-6,-7,-S)  
 VSWR: 1.15 Max.  
 Average Power: 1400 Watts

REVISIONS				
ZONE	REV	DESCRIPTION	DATE	APPROVED

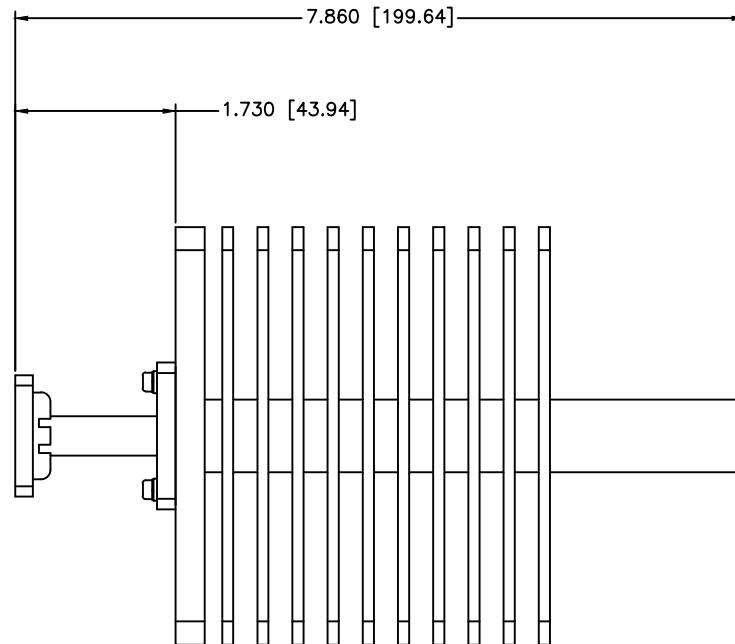

ORDERING INFORMATION

EXAMPLE PART NUMBER: WL-13-F  
 VERY HIGH POWER SERIES  
 FREQUENCY BAND  
 FLANGE TYPE

MATERIAL:  ALUMINUM 6061		MICROWAVE COMMUNICATIONS LABORATORIES INC. 7225 30TH AVE. N. SAINT PETERSBURG, FL 33710 TEL: (727) 344-6254 FAX: (727) 381-8116 http://www.mcli.com		SCALE: N/A
DRAWN: Paboon Luekhamhan		DATE: 05-03-2011	UNLESS OTHERWISE SPECIFIED: TOLERANCES IN (INCHES) OR (mm) (MILLIMETERS) FRACTIONS: ± 1/64 DECIMALS: ± 0.01 ± 0.005 ANGLE: ± 1/2°	
APPROVED: T. Nguyen		DATE: 05-03-2011	DRAWING TITLE: TERMINATION, WR62 1400 Watts	
CAGE CODE: 0D2L5		SIZE: C	REV: N/A	PART NO.: WL-13-F
DO NOT SCALE THE DRAWING		DWG NO.: 85659		