

GENERAL INFORMATION:

Full Waveguide Frequency Range
 VSWR 1.25 Typ.
 Units Sealed To Hold 10 PSI
 Body Material Aluminum, Copper-Brass Per Order
 Multiple Flange Available Upon Request, See Flange Types
 Type 7/16 (DIN) Female Precision Connectors
 Finishing Is Corrosion Resistant 316 Stainless Steel Epoxy Coating

ORDERING INFORMATION:

Materials: -A = Aluminum, -B = Copper/Brass
 Flange Type: -1 = CPRF, -2 = CPRG, -6 = Cover, -7 = Choke
 Example Part Number: WC-650D-A-1
 WC = W/G To 7/16 (DIN) Connector, -650D = W/G Size, -A = Aluminum, -1 = Flange Type

REVISIONS				
ZONE	REV	DESCRIPTION	DATE	APPROVED

STANDARD MODEL NO.	FREQUENCY RANGE (GHz)	W/G SIZE	DIM. -A-	DIM. -B-	DIM. -C-
WC-650D-A-1	1.12-1.17	WR650	2.92	5.00	2.40
WC-430D-A-1	1.70-2.60	WR430	2.37	4.00	2.30
WC-340D-A-1	2.20-3.30	WR340	2.15	3.50	2.29
WC-284D-A-1	2.60-3.95	WR284	1.97	2.50	1.51
WC-229D-A-1	3.30-4.90	WR229	1.85	2.25	1.35
WC-187D-A-1	3.95-5.85	WR187	1.72	2.60	1.90
WC-159D-A-1	4.90-7.05	WR159	1.68	2.23	1.70
WC-137D-A-1	5.85-8.20	WR137	1.59	2.00	1.47

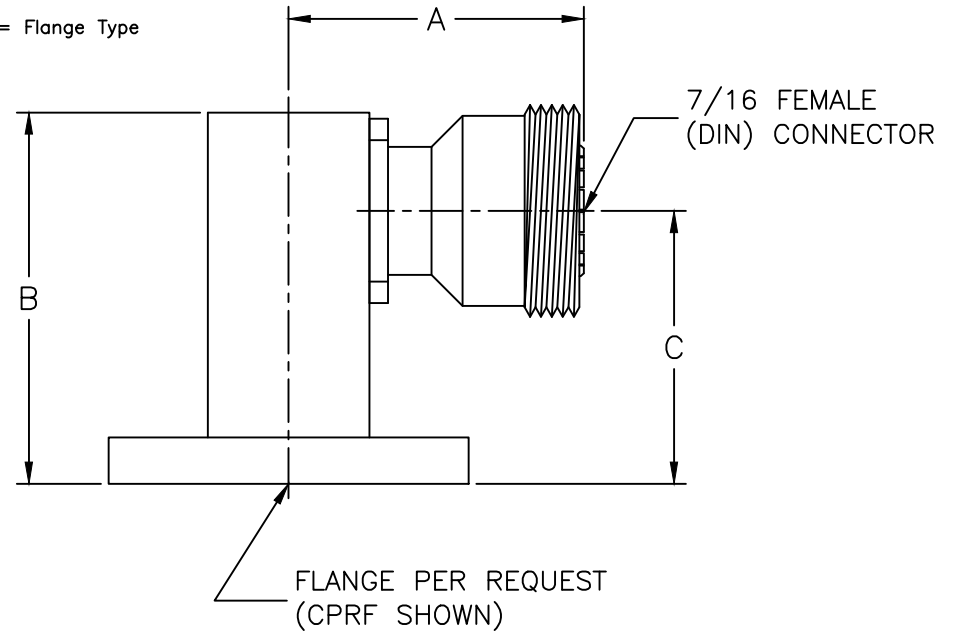

F = FLANGE TYPES

- 1 = CPRF
- 2 = CPRG
- 3 = CMR STANDARD
- 4 = CMR THRU
- 5 = CMR TAP
- 6 = UG-COVER
- 7 = UG-CHOKE
- 8 = UG-COVER/GROOVE
- 9 = PDR
- 10 = UDR

MATERIAL:			MICROWAVE COMMUNICATIONS LABORATORIES INC. 7255 30TH AVE. N. SAINT PETERSBURG, FL 33710 TEL: (727) 344-6254 FAX: (727) 381-6116 http://WWW.MCLI.COM		SCALE: N/A
UNLESS OTHERWISE SPECIFIED: TOLERANCES IN (INCHES) OR [mm] (MILLIMETERS) FRACTIONS: ± 1/64 DECIMALS: ±.02 ±.015 ANGLE: ±1/2°			DRAWING TITLE: WAVEGUIDE TO 7/16 ADAPTERS		SHEET: N/A
DRAWN: Paiboon Luexhamhan		DATE: 05-24-2011		PART NO. WC-D SERIES	
APPROVED: T. Nguyen		DATE: 05-24-2011		CAGE CODE: OD2L5	SIZE: A REV: N/A DWG NO.: 85694 DO NOT SCALE THE DRAWING

