

REVISIONS				
ZONE	REV	DESCRIPTION	DATE	APPROVED

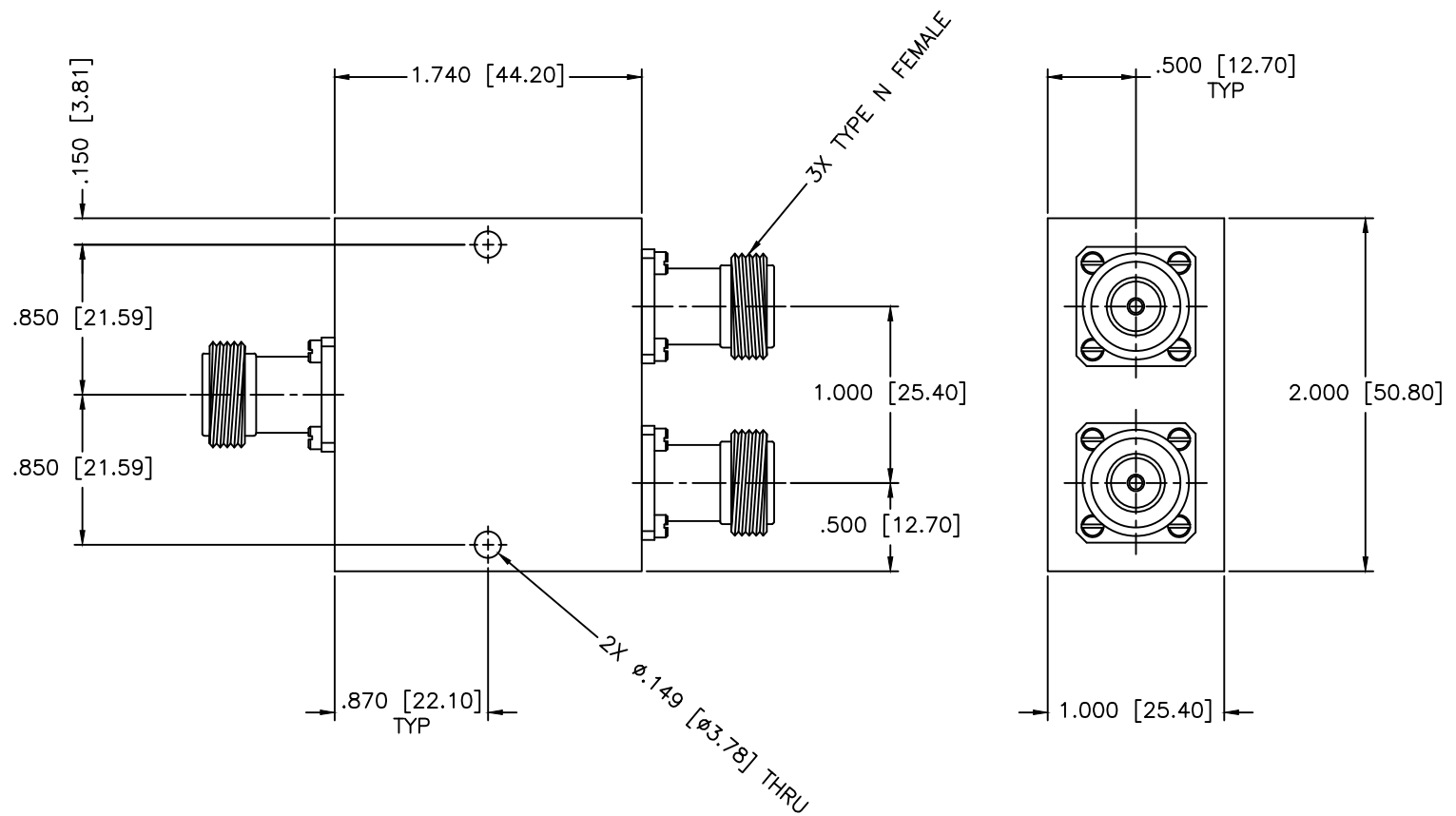

SPECIFICATIONS

Frequency Range: 0.5–2.3 GHz
 Insertion Loss: 0.45dB Max.
 Isolation: 17dB Min.
 VSWR: 1.45:1 Max.
 Amplitude Balance: ±0.4dB Max.
 Phase Balance: ±4 Deg Max.
 Power: 30 Watts

MATERIAL:	
DRAWN: Paiboon Luekhamhan	DATE: 06-28-1999
APPROVED: T. Nguyen	DATE: 06-28-1999

	MICROWAVE COMMUNICATIONS LABORATORIES INC. 7255 30TH AVE. N. SAINT PETERSBURG, FL 33710 TEL: (727) 344-6254 FAX: (727) 381-6116 http://WWW.MCLI.COM		SCALE: N/A
	UNLESS OTHERWISE SPECIFIED: TOLERANCES IN (INCHES) OR [mm] (MILLIMETERS) FRACTIONS: ± 1/64 DECIMALS: ±.01 ±.005 ANGLE: ±1/2°		SHEET: N/A
DRAWING TITLE: 2-WAY POWER DIVIDER		PART NO. PS2-36/NF	
CAGE CODE: OD2L5	SIZE: A	REV: N/A	DWG NO. 80896
DO NOT SCALE THE DRAWING			

PROPRIETARY NOTICE:
 THE INFORMATION IN THIS DRAWING IS PROPRIETARY
 AND SHALL NOT BE USED OR DISCLOSED WITHOUT WRITTEN
 PERMISSION FROM MICROWAVE COMMUNICATIONS
 LABORATORIES INC. (MCLI)
 THIRD ANGLE PROJECTION