

REVISIONS				
ZONE	REV	DESCRIPTION	Date	APPROVED

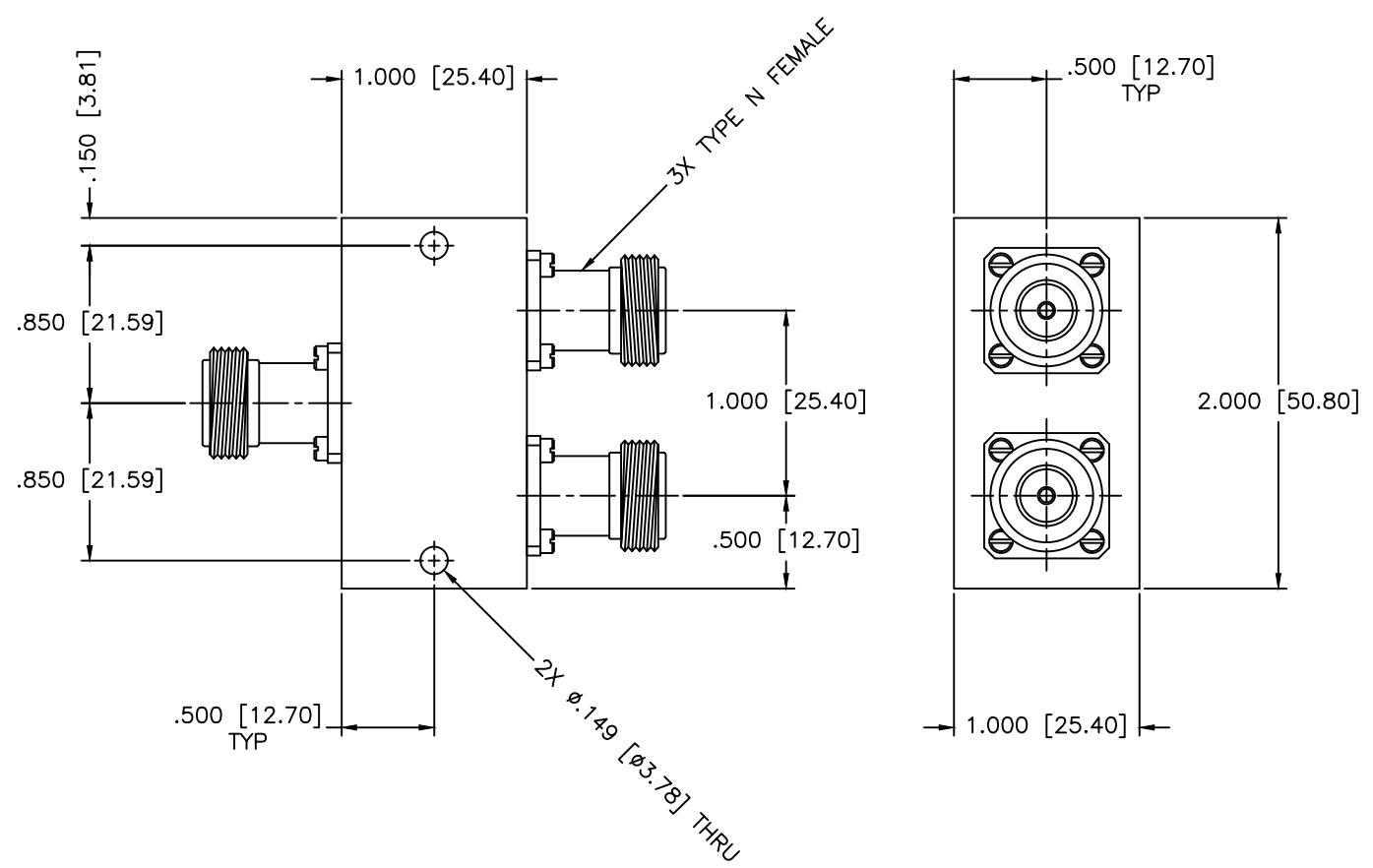

SPECIFICATIONS

Frequency Range: 3.5–4.5 GHz
 Insertion Loss: 0.70dB Max.
 Isolation: 17dB Min.
 Power: 30 Watts
 Amplitude Balance: ±0.1dB Max.
 VSWR In/Out: 1.40:1/1.30:1 Max.
 Phase Balance: ±6 Deg. Max.

MATERIAL:		MCLI MICROWAVE COMMUNICATIONS LABORATORIES INC. 7255 30TH AVE. N. SAINT PETERSBURG, FL 33710 TEL: (727) 344-6254 FAX: (727) 381-6116 http://WWW.MCLI.COM	SCALE:	N/A
			SHEET:	N/A
DRAWN: Paiboon Luekhamhan		DATE: 06-28-1999	DRAWING TITLE: 2-WAY POWER DIVIDER	
APPROVED: T. Nguyen		DATE: 06-28-1999	PART NO. PS2-28/NF	
<small> UNLESS OTHERWISE SPECIFIED: TOLERANCES IN (INCHES) OR [mm] (MILLIMETERS) FRACTIONS: ± 1/64 DECIMALS: ± .01 ± .005 ANGLE: ± 1/2° </small>		<small> FREQUENCY NOTES: THE INFORMATION IN THIS DRAWING IS PROPRIETARY AND SHALL NOT BE USED OR DISCLOSED WITHOUT WRITTEN PERMISSION FROM MICROWAVE COMMUNICATIONS LABORATORIES INC. (MCLI) </small>	CAGE CODE: OD2L5	SIZE: A REV: N/A DO NOT SCALE THE DRAWING
		<small> THIRD ANGLE PROJECTION </small>	DWG NO. 80889	