

REVISIONS				
ZONE	REV	DESCRIPTION	Date	APPROVED

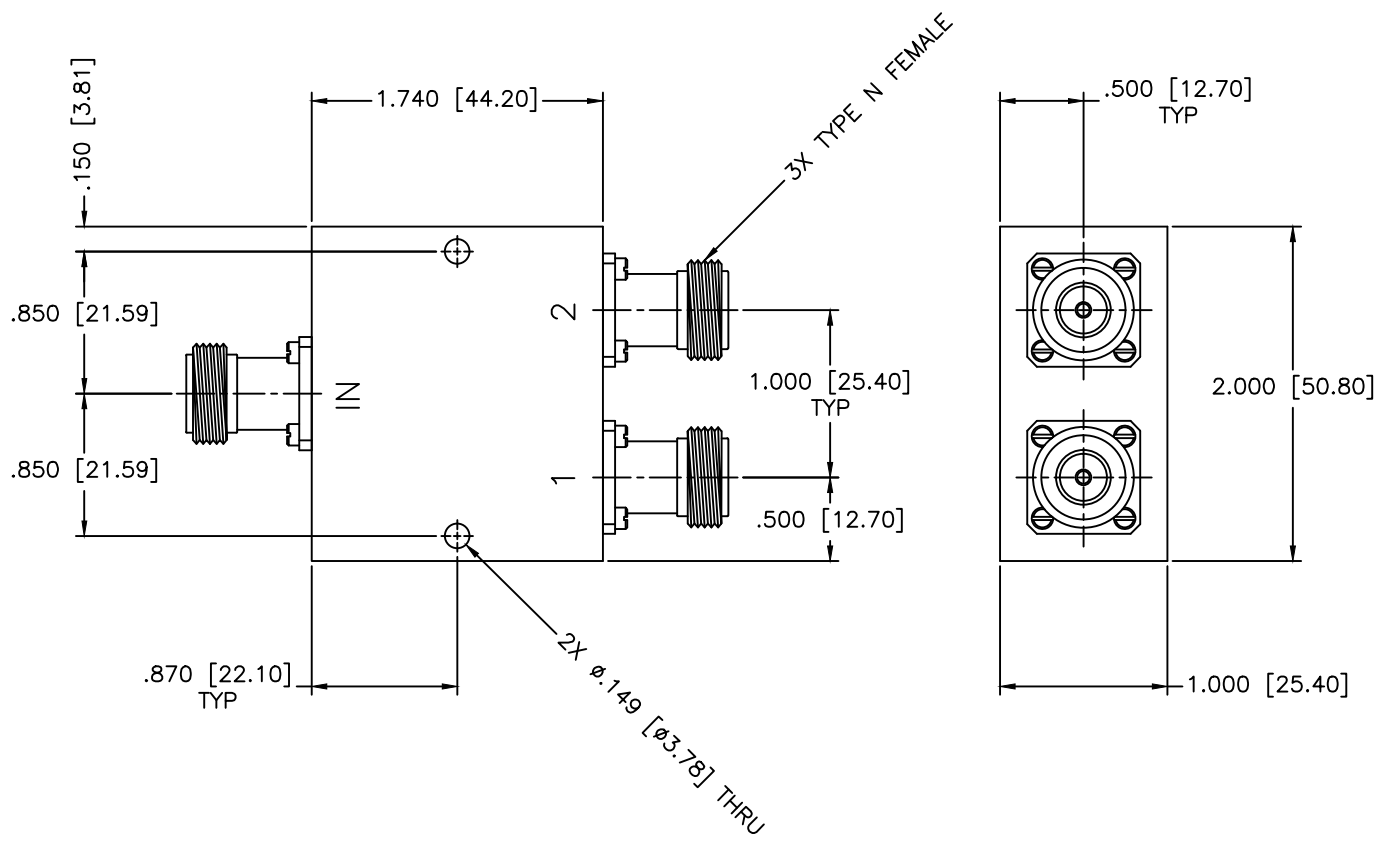

**SPECIFICATIONS**

Frequency Range: 1-3 GHz  
 Insertion Loss: 0.4dB Min.  
 Isolation: 20dB Min.  
 Power: 30W (Load vswr @ 1.2)  
 Amplitude Balance: ±0.2dB Max.  
 VSWR In/Out: 1.35:1/1.30:1 Max.  
 Phase Balance: ±6 Deg. Max.

MATERIAL:		<b>MCLI</b> MICROWAVE COMMUNICATIONS LABORATORIES INC. 7255 30TH AVE. N. SAINT PETERSBURG, FL 33710 TEL: (727) 344-6254 FAX: (727) 381-6116 http://WWW.MCLI.COM	SCALE:	N/A
			SHEET:	N/A
		UNLESS OTHERWISE SPECIFIED: TOLERANCES IN (INCHES) OR [mm] (MILLIMETERS) FRACTIONS: ± 1/64 DECIMALS: ±.01 ±.005 ANGLE: ±1/2°	DRAWING TITLE: <b>2-WAY POWER DIVIDERS</b>	
		<small>FREQUENTLY MISUSED:          THIS INFORMATION IN THIS DRAWING IS PROPRIETARY          AND SHALL NOT BE USED OR DISCLOSED WITHOUT WRITTEN          PERMISSION FROM MICROWAVE COMMUNICATIONS          LABORATORIES INC. (MCLI)</small>	PART NO. <b>PS2-23/NF</b>	
DRAWN:	DATE:	THIRD ANGLE PROJECTION	CAGE CODE:	SIZE:
Paiboon Luekhamhan	06-28-1999		OD2L5	N/A
APPROVED:	DATE:			N/A
T. Nguyen	06-28-1999			DWG NO.
			DO NOT SCALE THE DRAWING	
			80075	