

REVISIONS				
ZONE	REV	DESCRIPTION	DATE	APPROVED

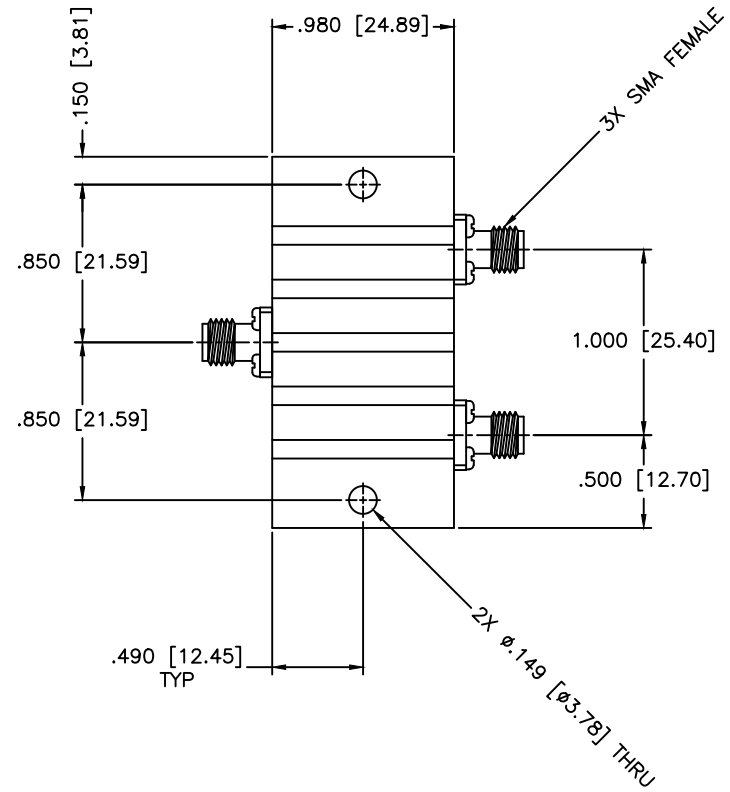
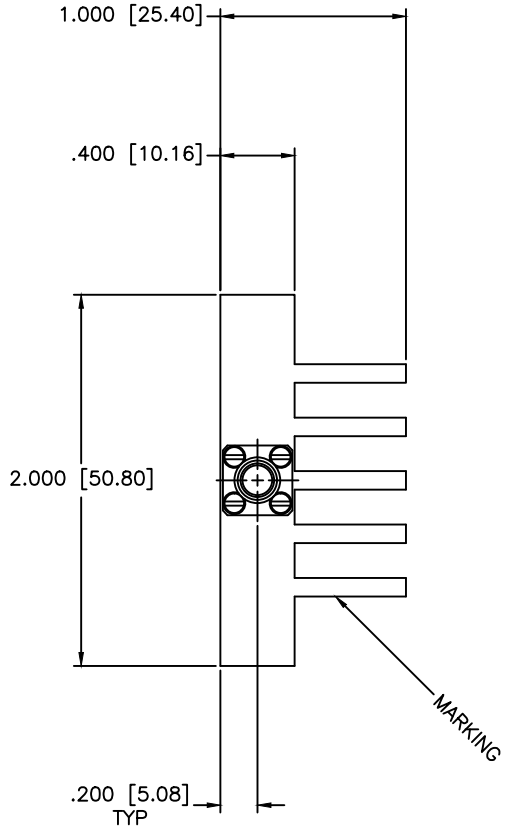

SPECIFICATIONS

Frequency Range: 5.0–5.3 GHz
 Insertion Loss: 0.3dB Typ./0.5dB Max.
 Isolation: 20dB Typ./17dB Min.
 Amplitude Balance: ±0.3dB
 Phase Balance: ±5 Deg. Max.
 VSWR: 1.35:1 Typ./1.45:1 Max.
 Power: 60W CW Max.

MATERIAL:			MICROWAVE COMMUNICATIONS LABORATORIES INC. 7255 30TH AVE. N. SAINT PETERSBURG, FL 33710 TEL: (727) 344-6254 FAX: (727) 381-6116 http://WWW.MCLI.COM		SCALE:	N/A
					SHEET:	N/A
		UNLESS OTHERWISE SPECIFIED: TOLERANCES IN (INCHES) OR [mm] (MILLIMETERS) FRACTIONS: ± 1/64 DECIMALS: ±.01 ±.005 ANGLE: ±1/2°	DRAWING TITLE:			
			2-WAY POWER DIVIDER			
			PART NO.			
			PS2-216-60			
DRAWN:	DATE:	PROPRIETARY NOTICE: THE INFORMATION IN THIS DRAWING IS PROPRIETARY AND SHALL NOT BE USED OR DISCLOSED WITHOUT WRITTEN PERMISSION FROM MICROWAVE COMMUNICATIONS LABORATORIES INC. (MCLI)	CAGE CODE:	SIZE:	REV:	DWG NO.
APPROVED:	DATE:		OD2L5	A	N/A	85046
		THIRD ANGLE PROJECTION	DO NOT SCALE THE DRAWING			