

REVISIONS				
ZONE	REV	DESCRIPTION	Date	APPROVED

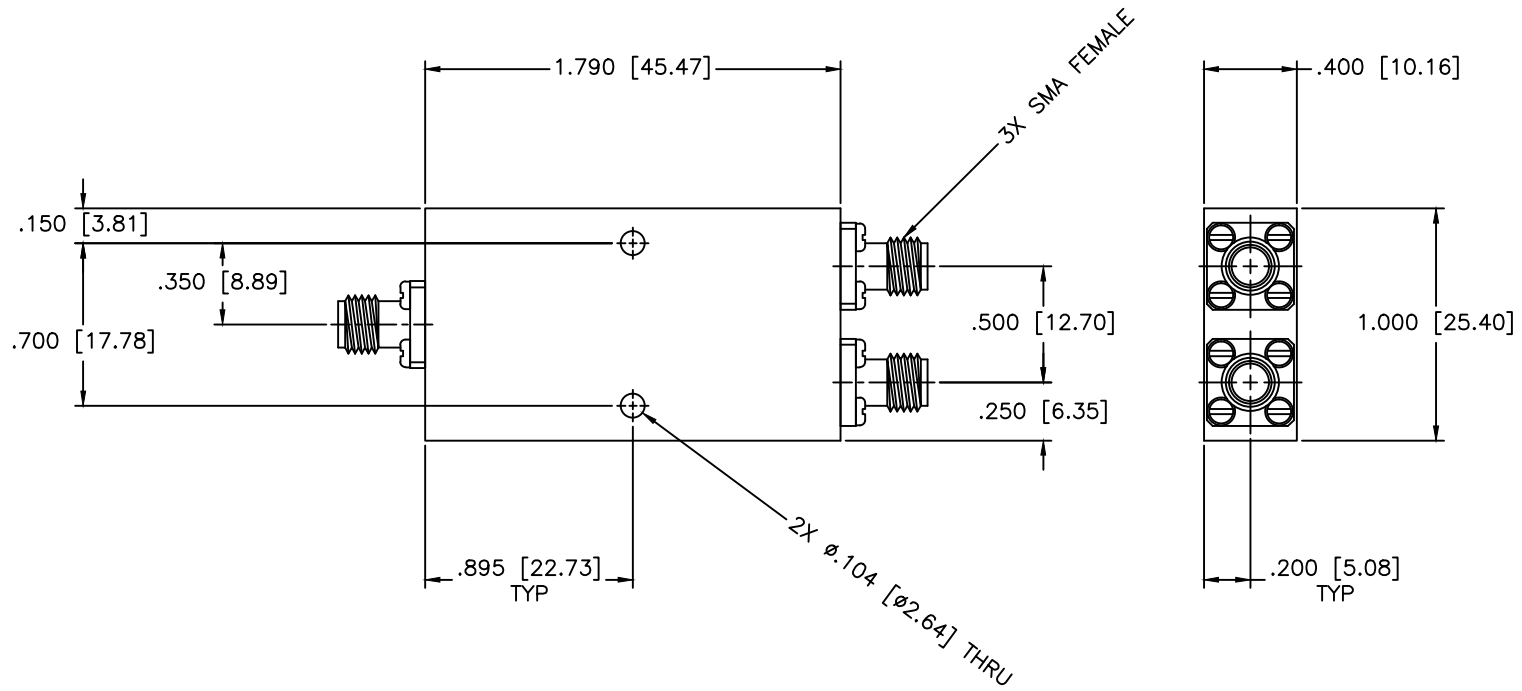

**SPECIFICATIONS**

Frequency Range: 2–20 GHz  
 Isolation: 17dB Min.  
 VSWR: 1.70:1 Max.  
 Insertion Loss: 1.8dB Max.  
 Amplitude Balance: ±0.5dB Max.  
 Phase Balance: ±6 Degrees Max.  
 Power: 30W (Load vswr@1.2)

MATERIAL:		<b>MCLI</b> MICROWAVE COMMUNICATIONS LABORATORIES INC. 7255 30TH AVE. N. SAINT PETERSBURG, FL 33710 TEL: (727) 344-6254 FAX: (727) 381-6116 <a href="http://WWW.MCLI.COM">http://WWW.MCLI.COM</a>	SCALE:	N/A	
UNLESS OTHERWISE SPECIFIED: TOLERANCES IN (INCHES) OR [mm] (MILLIMETERS) FRACTIONS: ± 1/64 DECIMALS: ±.01 ±.005 ANGLE: ±1/2°			DRAWING TITLE:	2-WAY POWER DIVIDER	
DRAWN: Paiboon Luekhamhan	DATE: 02-09-1998	PROPRIETARY NOTICE: THE INFORMATION IN THIS DRAWING IS PROPRIETARY AND SHALL NOT BE USED OR DISCLOSED WITHOUT WRITTEN PERMISSION FROM MICROWAVE COMMUNICATIONS LABORATORIES INC. (MCLI)	PART NO.:	PS2-137	
APPROVED: T. Nguyen	DATE: 02-09-1998	THIRD ANGLE PROJECTION 	CAGE CODE:	OD2L5	
		SIZE:	N/A	REV:	N/A
		DO NOT SCALE THE DRAWING		DWG NO.:	80846