

REVISIONS				
ZONE	REV	DESCRIPTION	Date	APPROVED

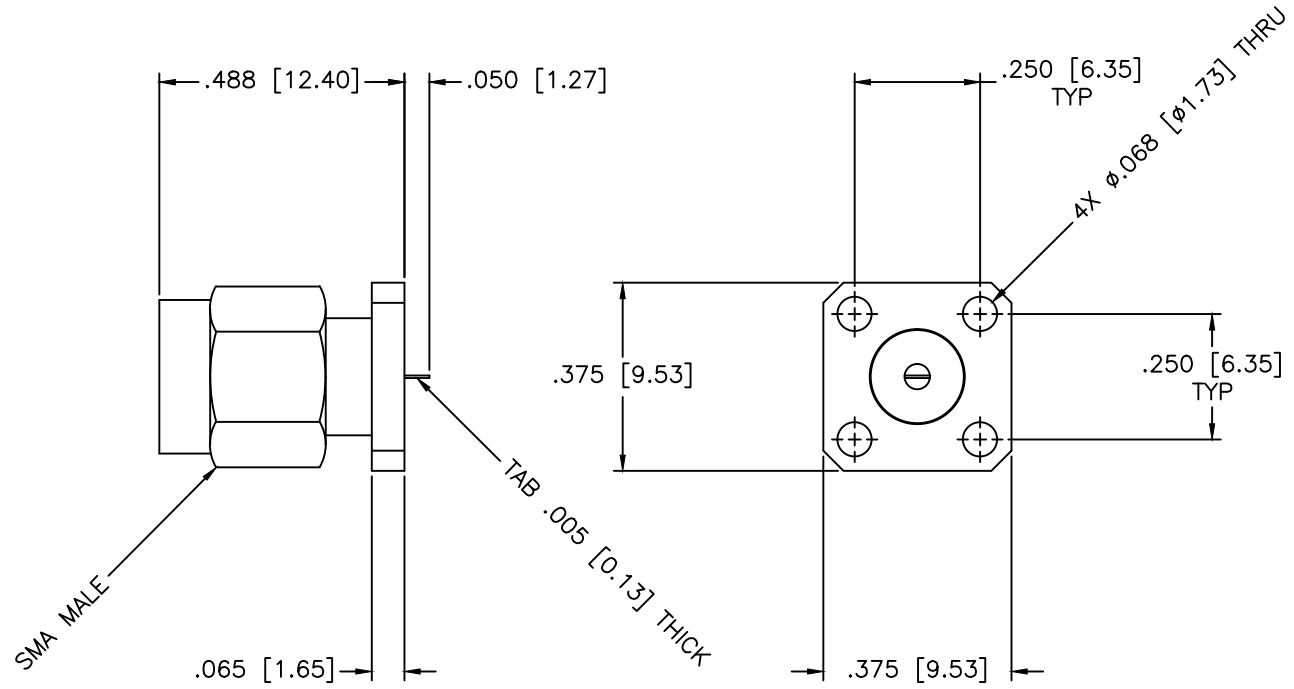

SPECIFICATIONS

Frequency Range: DC-18 GHz
 VSWR: 1.15 Max.
 Impedance: 50 OHMS
 Temperature Range: -65°C to +85°C

MATERIAL & FINISHING

Shell: Stainless steel, Passivated
 Contact: Copper, Gold plated
 Insulator: PTFE Teflon

MATERIAL:		MCLI MICROWAVE COMMUNICATIONS LABORATORIES INC. 7255 30TH AVE. N. SAINT PETERSBURG, FL 33710 TEL: (727) 344-6254 FAX: (727) 381-6116 http://WWW.MCLI.COM	SCALE:	N/A		
			SHEET:	N/A		
DRAWING TITLE:		SMA MALE CONNECTOR				
PART NO.:		MC18-430				
DRAWN:	DATE:	<small>UNLESS OTHERWISE SPECIFIED: TOLERANCES IN (INCHES) OR [mm] (MILLIMETERS) FRACTIONS: ± 1/64 DECIMALS: ±.01 ±.005 ANGLE: ±1/2°</small>	CAGE CODE:	SIZE:	REV:	DWG. NO.:
Paiboon Luekhamhan	10-05-209		OD2L5	N/A	N/A	84598
APPROVED:	DATE:	<small>PROPRIETARY NOTICE: THE INFORMATION IN THIS DRAWING IS PROPRIETARY AND SHALL NOT BE USED OR DISCLOSED WITHOUT WRITTEN PERMISSION FROM MICROWAVE COMMUNICATIONS LABORATORIES INC. (MCLI)</small>	DO NOT SCALE THE DRAWING			
T. Nguyen	10-05-2009					