

REVISIONS				
ZONE	REV	DESCRIPTION	Date	APPROVED

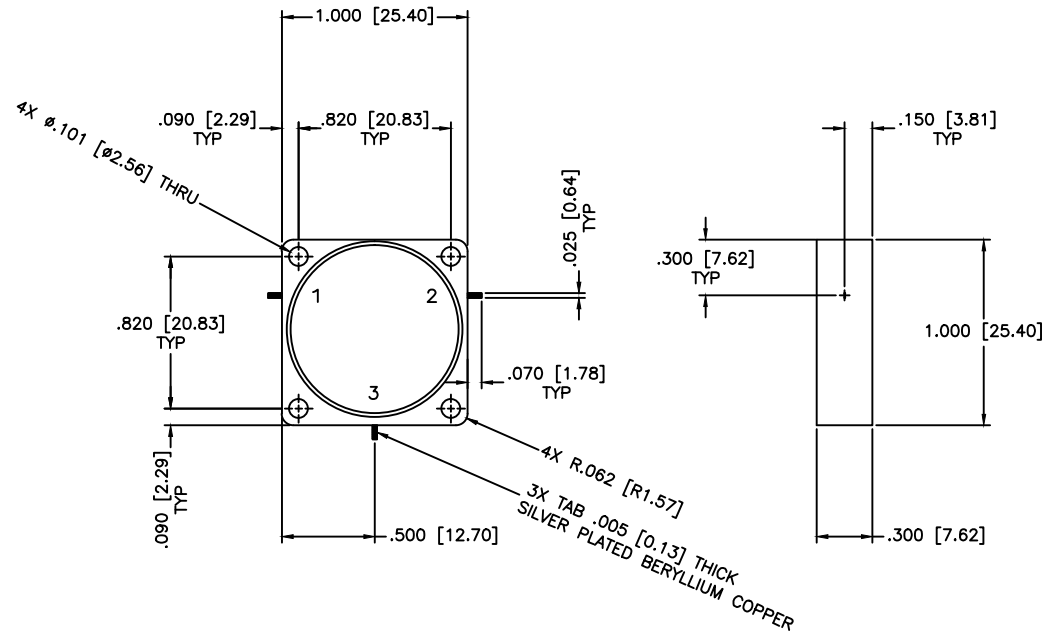

SPECIFICATIONS

Frequency Range: 1.020–1.040 GHz
 Isolation: 20dB Min.
 Insertion loss: 0.3dB Max.
 VSWR: 1.25:1 Max.
 Operating Temperature: -40°C to +85°C
 Average Power: 15W
 Peak Power: 750W, 2% Duty Cycle

MATERIAL:		MCLI MICROWAVE COMMUNICATIONS LABORATORIES INC. 7255 30TH AVE. N. SAINT PETERSBURG, FL 33710 TEL: (727) 344-6254 FAX: (727) 381-6116 http://www.mcli.com	SCALE:	N/A
			SHEET:	N/A
UNLESS OTHERWISE SPECIFIED: TOLERANCES IN (INCHES) OR [mm] (MILLIMETERS) FRACTIONS: ± 1/64 DECIMALS: ±.01 ±.005 ANGLE: ±1/2°		DRAWING TITLE: DROP IN CIRCULATORS		
DRAWN: Paiboon Luekhamhan		PART NO.: MC-34-750		
DATE: 05-12-2015		CAGE CODE: OD2L5		
APPROVED: T. Nguyen		DATE: 05-12-2015		
THIRD ANGLE PROJECTION		SIZE: A		
		REV: N/A		
		DWG NO.: XXXXX		
DO NOT SCALE THE DRAWING				