

REVISIONS				
ZONE	REV	DESCRIPTION	DATE	APPROVED

HOLE OPTION  
 4-40UNC-2B .170 DEEP  
 6-32UNC-2B THROUGH HOLE  
 8-32UNC-2B THROUGH HOLE  
 Ø.165 THROUGH HOLE

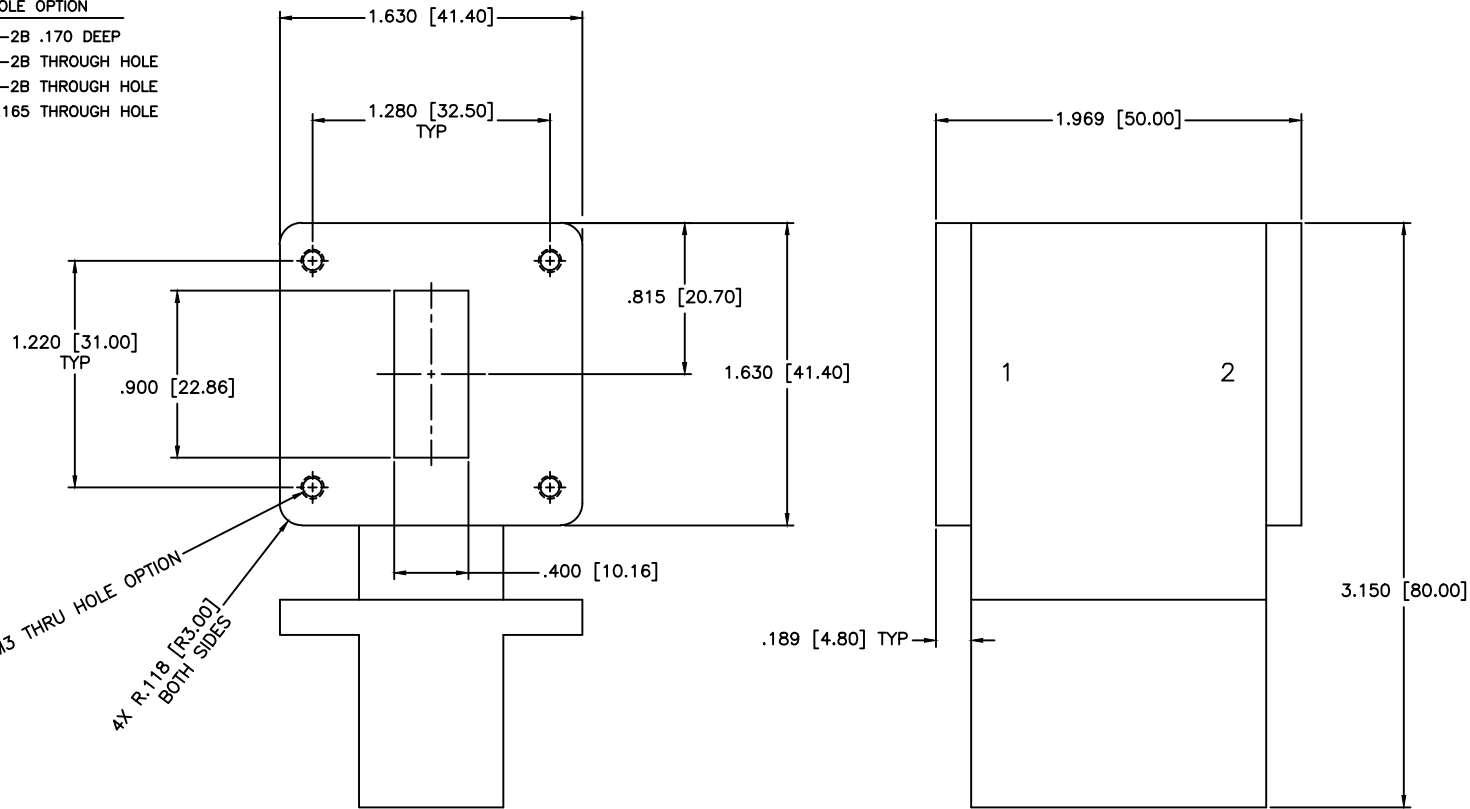

SPECIFICATIONS  
 FREQUENCY RANGE: 10.7-11.7 GHz  
 EIA DESIGN (1-2): WR90  
 VSWR: 1.18:1 Max.  
 INSERTION LOSS: 0.20dB Max.  
 ISOLATION: 22dB Max.  
 AVERAGE POWER: 5W, 500W Peak  
 OPERATING TEMPERATURE: -30°C to +70°C

MATERIAL:		MICROWAVE COMMUNICATIONS LABORATORIES INC. 7255 30TH AVE. N. SAINT PETERSBURG, FL 33710 TEL: (727) 344-6254 FAX: (727) 381-6116 http://WWW.MCLI.COM	SCALE:	N/A
			SHEET:	N/A
		UNLESS OTHERWISE SPECIFIED: TOLERANCES IN (INCHES) OR [mm] (MILLIMETERS) FRACTIONS: ± 1/64 DECIMALS: ±.01 ±.005 ANGLE: ±1/2°	DRAWING TITLE: WR90 WAVEGUIDE ISOLATOR	
		PROPRIETARY NOTICE: THE INFORMATION IN THIS DRAWING IS PROPRIETARY AND SHALL NOT BE USED OR DISCLOSED WITHOUT WRITTEN PERMISSION FROM MICROWAVE COMMUNICATIONS LABORATORIES INC. (MCLI)	PART NO. ISW-6	
DRAWN:	DATE:	THIRD ANGLE PROJECTION 	CAGE CODE:	DWG NO.
APPROVED:	DATE:		OD2L5	85525
		DO NOT SCALE THE DRAWING		