

REVISIONS				
ZONE	REV	DESCRIPTION	DATE	APPROVED

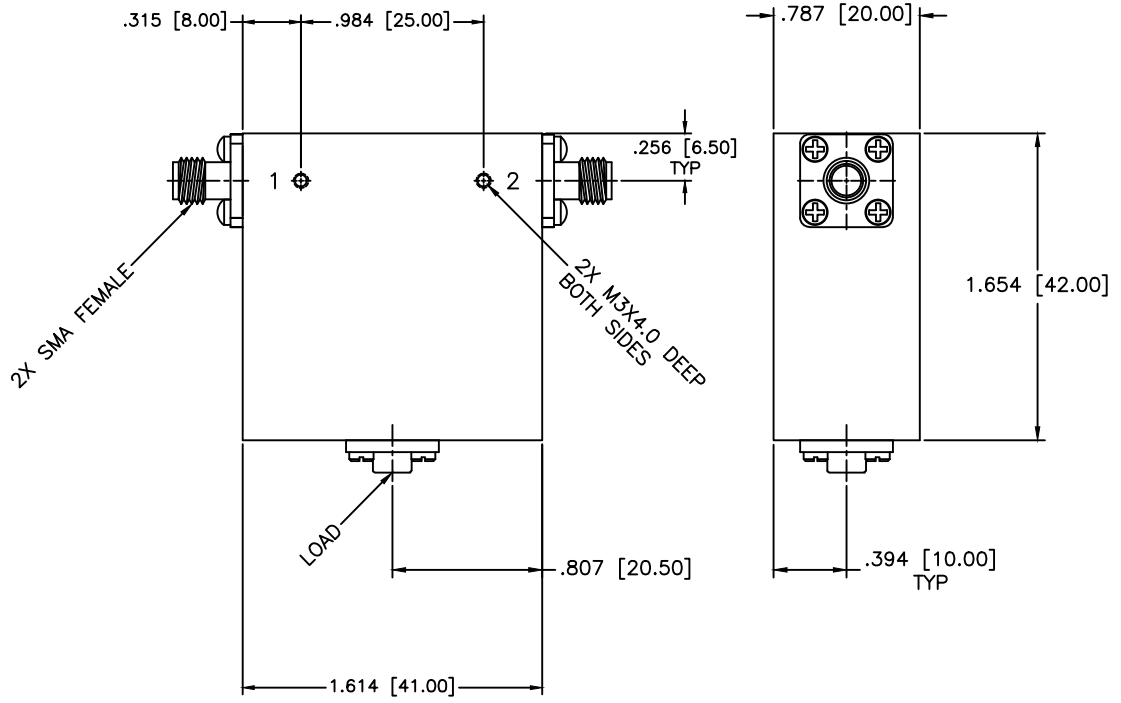

SPECIFICATIONS

Frequency Range: 2-4 GHz
 Isolation: 20dB Typ.
 Insertion loss: 0.50 dB Max.
 VSWR: 1.35:1 Max.
 Power Average: 50W
 Reflective Power: 10W
 Operating Temperature: -30°C TO +70°C

MATERIAL:		MICROWAVE COMMUNICATIONS LABORATORIES INC. 7255 30TH AVE. N. SAINT PETERSBURG, FL 33710 TEL: (727) 344-6254 FAX: (727) 381-6116 http://WWW.MCLI.COM	SCALE:	N/A
			SHEET:	N/A
		UNLESS OTHERWISE SPECIFIED: TOLERANCES IN (INCHES) OR [mm] (MILLIMETERS) FRACTIONS: ± 1/64 DECIMALS: ±.01 ±.005 ANGLE: ±1/2°	DRAWING TITLE: ISOLATOR	
DRAWN: Paiboon Luekhamhan		DATE: 10-08-1998	PART NO. IS-10	
APPROVED: T. Nguyen		DATE: 10-08-1998	CAGE CODE: OD2L5	SIZE: A REV: N/A DWG NO. 81155
		PROPRIETARY NOTICE: THE INFORMATION IN THIS DRAWING IS PROPRIETARY AND SHALL NOT BE USED OR DISCLOSED WITHOUT WRITTEN PERMISSION FROM MICROWAVE COMMUNICATIONS LABORATORIES INC. (MCLI)	DO NOT SCALE THE DRAWING	