

| REVISIONS |     |             |      |          |
|-----------|-----|-------------|------|----------|
| ZONE      | REV | DESCRIPTION | DATE | APPROVED |
|           |     |             |      |          |

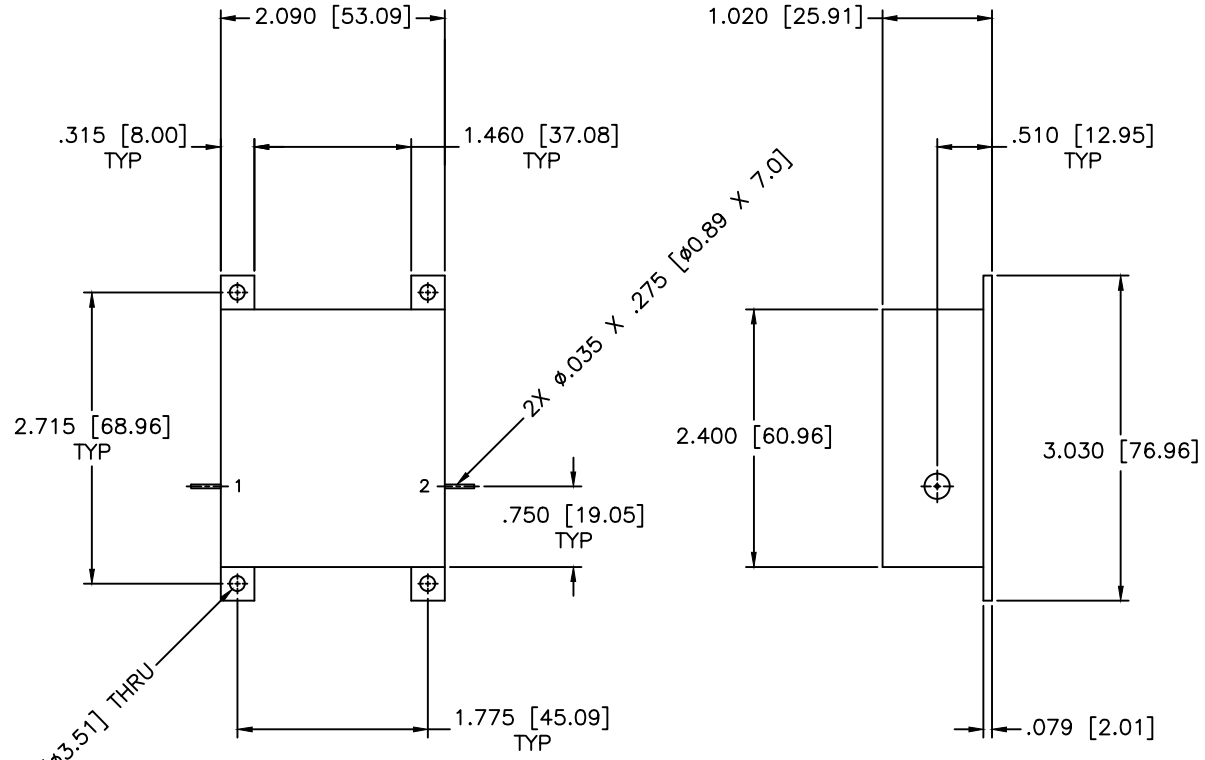

| MCLI MODEL NUMBER | FREQUENCY RANGE (MHz) | INSERTION LOSS (dB Max.) | REVERSE ISOLATOR (dB Min.) | VSWR Max. | FWD/REV POWER (Watts) | TEMPERATURE RANGE (Deg. C) |
|-------------------|-----------------------|--------------------------|----------------------------|-----------|-----------------------|----------------------------|
| DL-5              | 156-162               | 0.5                      | 18                         | 1.35:1    | 100/20                | -20 to +70                 |
| DL-6              | 168-230               | 0.8                      | 18                         | 1.40:1    | 100/20                | -40 to +80                 |
| DL-7              | 230-270               | 0.8                      | 20                         | 1.30:1    | 100/20                | -40 to +80                 |

|                             |  |  |  |  |  |               |
|-----------------------------|--|--|--|--|--|---------------|
| MATERIAL:                   |  |  |  | MICROWAVE COMMUNICATIONS LABORATORIES INC.<br>7250 30TH AVE. N. SAINT PETERSBURG, FL 33710<br>TEL: (727) 544-6254 FAX: (727) 381-0110<br>http://www.mcli.com |  | SCALE: N/A    |
| DRAWING TITLE:              |  | UNLESS OTHERWISE SPECIFIED:<br>TOLERANCES<br>IN (INCHES) OR (mm) (MILLIMETERS)<br>FRACTIONS: ± 1/64<br>DECIMALS: ± .02 ± .015<br>ANGLE: ± 1/2° |  | DRAWING TITLE: LUMPED ELEMENT COAXIAL ISOLATOR   |  | SHEET: N/A    |
| PART NO.:                   |  | DL-5 to DL-7   |  | CAGE CODE: OD2L5   |  | SIZE: N/A     |
| DRAWING: Paiboon Luekhamhan |  | DATE: 08-03-2011   |  | REV: N/A   |  | DWG NO. 85798 |
| APPROVED: T. Nguyen         |  | DATE: 08-03-2011   |  | DO NOT SCALE THE DRAWING   |  |               |