

REVISIONS				
ZONE	REV	DESCRIPTION	DATE	APPROVED

HOLE OPTION
 4-40UNC-2B .170 DEEP
 6-32UNC-2B THROUGH HOLE
 8-32UNC-2B THROUGH HOLE
 ø.165 THROUGH HOLE

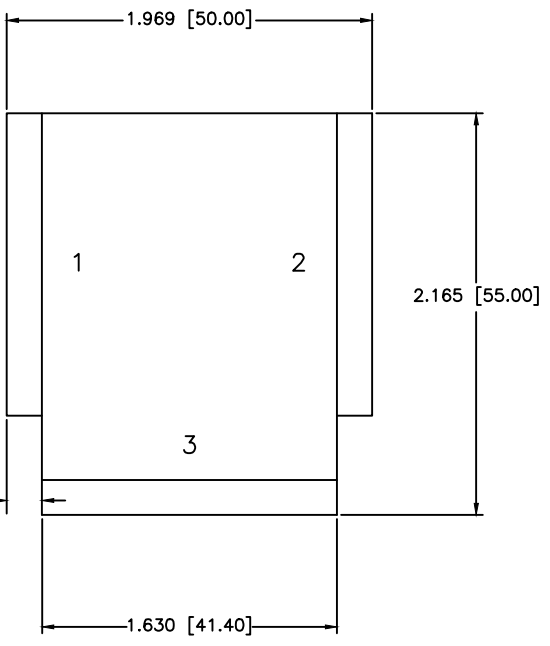
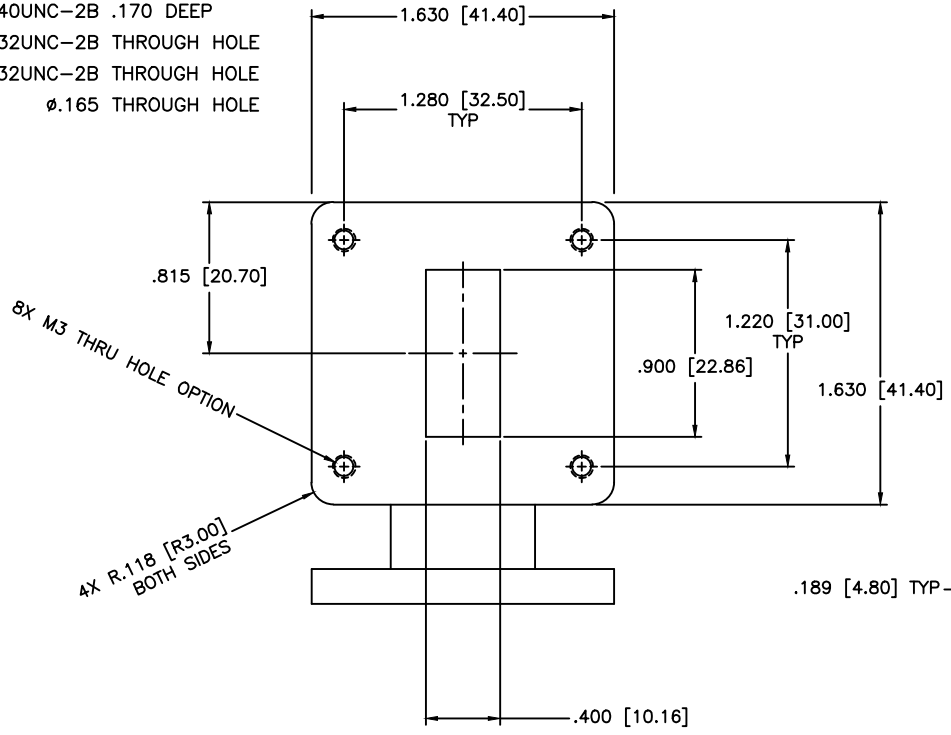

SPECIFICATIONS

FREQUENCY RANGE: 10-11 GHz
 EIA DESIGN (1,2,3): WR90
 VSWR: 1.18:1 Max.
 INSERTION LOSS: 0.20dB Max.
 ISOLATION: 22dB Min.
 AVERAGE POWER: 200W, 500W Peak
 OPERATING TEMPERATURE: -30°C to +70°C

MATERIAL:	
/	
DRAWN: Paiboon Luethamhan	DATE: 02-15-2011
APPROVED: T. Nguyen	DATE: 02-15-2011

MCLI	MICROWAVE COMMUNICATIONS LABORATORIES INC. 7255 30TH AVE. N. SAINT PETERSBURG, FL 33710 TEL: (727) 344-6254 FAX: (727) 381-6116 http://WWW.MCLI.COM		SCALE: N/A
	UNLESS OTHERWISE SPECIFIED: TOLERANCES IN (INCHES) OR [mm] (MILLIMETERS) FRACTIONS: ± 1/64 DECIMALS: ±.01 ±.005 ANGLE: ±1/2°		SHEET: N/A
DRAWING TITLE: WR90 WAVEGUIDE CIRCULATOR		PART NO. CSW-5	
CAGE CODE: OD2L5	SIZE: A	REV: N/A	DWG NO. 85528
DO NOT SCALE THE DRAWING			

