

REVISIONS				
ZONE	REV	DESCRIPTION	DATE	APPROVED

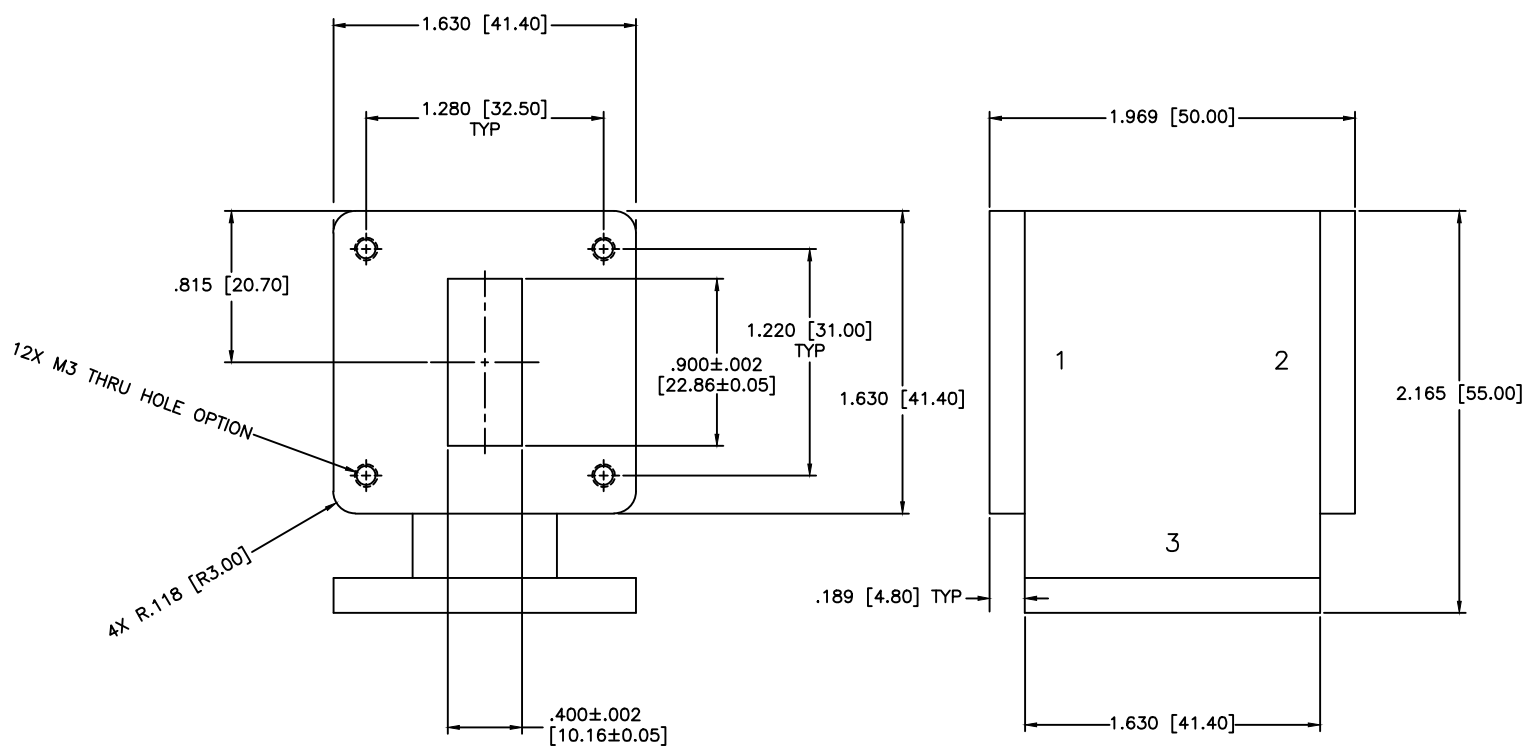

SPECIFICATIONS

- FREQUENCY RANGE: 9.1–9.5 GHz
- RETURN LOSS: 23dB Max.
- INSERTION LOSS: 0.20dB Max.
- ISOLATION: 23dB Min.
- AVERAGE POWER: 4W
- OPERATING TEMPERATURE: -15°C to +75°C
- SPECIFICATION: +5°C to +40°C
- RETURN LOSS: 28dB Max.
- INSERTION LOSS: 0.18dB Max.
- ISOLATION: 28dB Min.

MATERIAL: ALUMINUM, PAINTED BLACK		 MICROWAVE COMMUNICATIONS LABORATORIES INC. 7255 30TH AVE. N. SAINT PETERSBURG, FL 33710 TEL: (727) 344-6254 FAX: (727) 381-6116 http://WWW.MCLI.COM	SCALE: N/A
			SHEET: N/A
DRAWN: Paiboon Luekhamhan		DATE: 02-15-2011	DRAWING TITLE: WR90 WAVEGUIDE CIRCULATOR PART NO. CSW-37
APPROVED: T. Nguyen		DATE: 02-15-2011	
UNLESS OTHERWISE SPECIFIED: TOLERANCES IN (INCHES) OR [mm] (MILLIMETERS) FRACTIONS: ± 1/64 DECIMALS: ±.01 ±.005 ANGLE: ±1/2°		PROPRIETARY NOTICE: THE INFORMATION IN THIS DRAWING IS PROPRIETARY AND SHALL NOT BE USED OR DISCLOSED WITHOUT WRITTEN PERMISSION FROM MICROWAVE COMMUNICATIONS LABORATORIES INC. (MCLI)	CAGE CODE: 0D2L5
		SIZE: A	REV: N/A
		DO NOT SCALE THE DRAWING	
		DWG NO. 86980	

