

REVISIONS				
ZONE	REV	DESCRIPTION	DATE	APPROVED

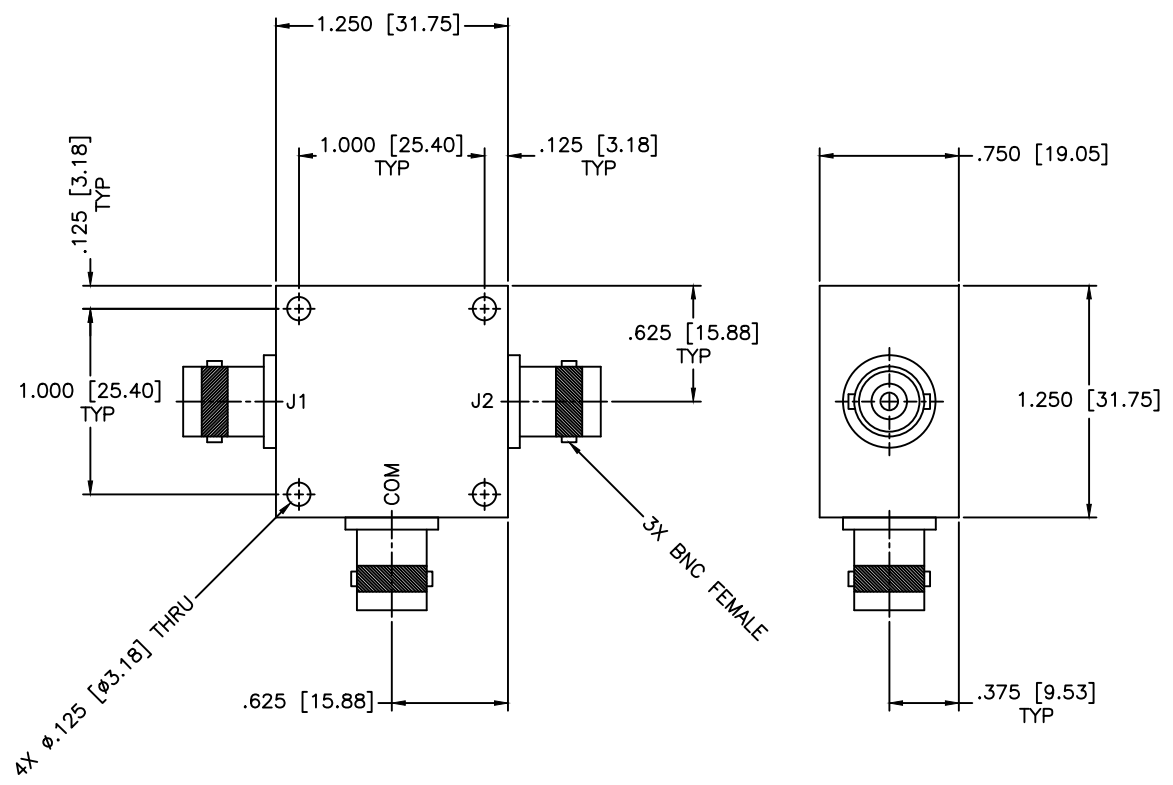

**SPECIFICATIONS**

Frequency Range: 5–300 MHz  
 Isolation: 23dB Min.  
 VSWR: 1.18:1 Max.  
 Insertion Loss: 1.2dB Max.  
 Amplitude Balance: ±0.3dB Max.  
 Phase Balance: ±3 Deg. Max.  
 Impedance: 50 Ohm  
 Operating Temperature: -40°C to +85°C

MATERIAL:			MICROWAVE COMMUNICATIONS LABORATORIES INC. 7255 30TH AVE. N. SAINT PETERSBURG, FL 33710 TEL: (727) 344-6254 FAX: (727) 381-6116 http://WWW.MCLI.COM		SCALE:	N/A
			UNLESS OTHERWISE SPECIFIED: TOLERANCES IN (INCHES) OR (mm) (MILLIMETERS) FRACTIONS: ± 1/64 DECIMALS: ±.03 ±.009 ANGLE: ±1/2°		DRAWING TITLE:	2-WAY POWER DIVIDER
DRAWN:		DATE:		PART NO.		PL2-14/BF
Paiboon Luekhamhan 05-13-1998		T. Nguyen 05-13-1998		PROPRIETARY NOTICE: THE INFORMATION IN THIS DRAWING IS PROPRIETARY AND SHALL NOT BE USED OR DISCLOSED WITHOUT WRITTEN PERMISSION FROM MICROWAVE COMMUNICATIONS LABORATORIES INC. (MCLI)	CAGE CODE:	OD2L5
APPROVED:		DATE:		THIRD ANGLE PROJECTION	SIZE:	A
					REV:	N/A
					DWG NO.	81209
					DO NOT SCALE THE DRAWING	