

REVISIONS				
ZONE	REV	DESCRIPTION	DATE	APPROVED

HOLE OPTION
 4-40UNC-2B .170 DEEP
 6-32UNC-2B THROUGH HOLE
 8-32UNC-2B THROUGH HOLE
 Ø.165 THROUGH HOLE

8X M3 THRU HOLE OPTION

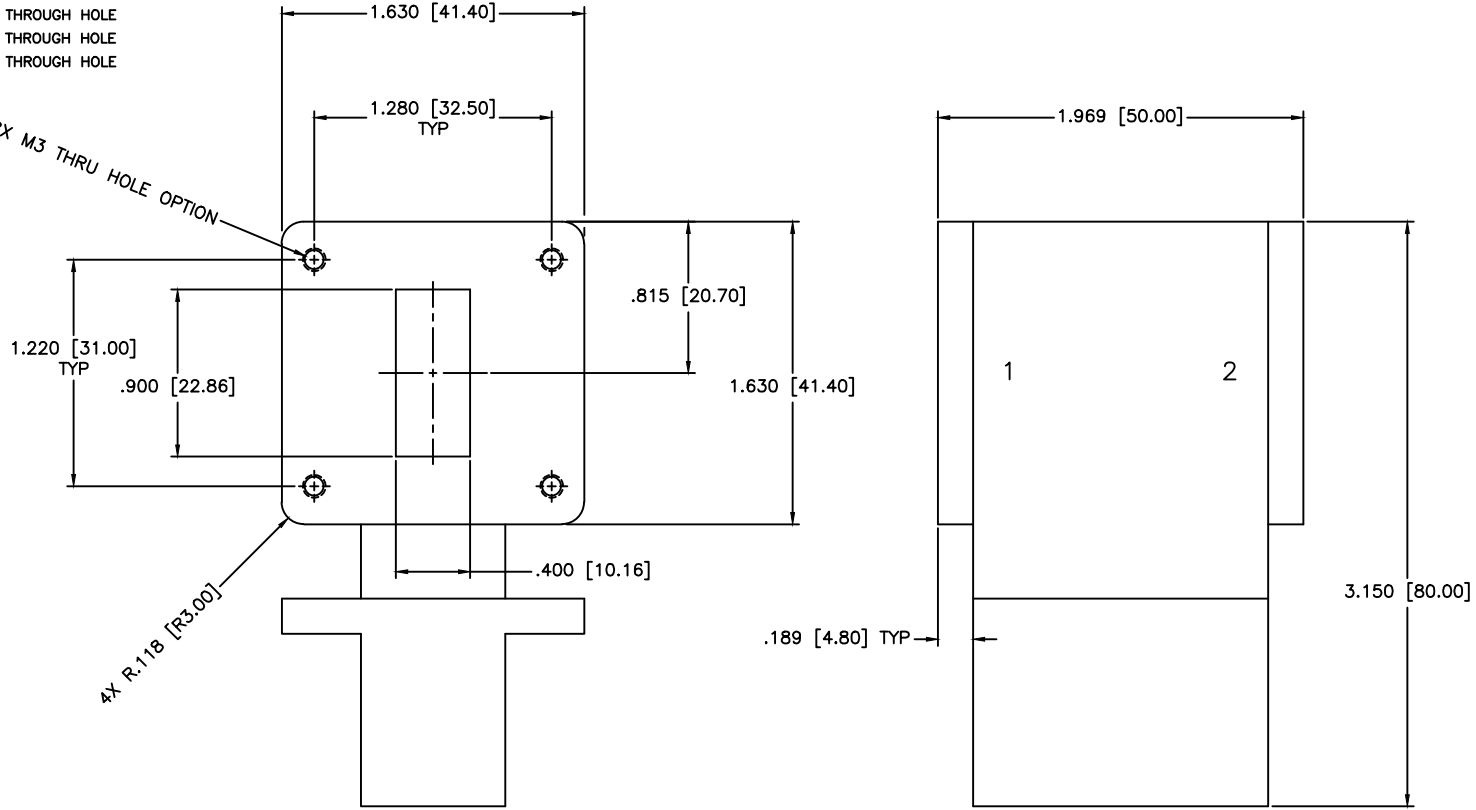

SPECIFICATIONS

FREQUENCY RANGE: 9-10 GHz
 EIA DESIGN (1-2): WR90
 VSWR: 1.18:1 Max.
 INSERTION LOSS: 0.20dB Max.
 ISOLATION: 22dB Max.
 POWER: 5W, 500W Peak
 OPERATING TEMPERATURE: -30°C to +70°C

MATERIAL:			MICROWAVE COMMUNICATIONS LABORATORIES INC. 7255 30TH AVE. N. SAINT PETERSBURG, FL 33710 TEL: (727) 344-6254 FAX: (727) 381-6116 http://WWW.MCLI.COM		SCALE: N/A
UNLESS OTHERWISE SPECIFIED: TOLERANCES IN (INCHES) OR [mm] (MILLIMETERS) FRACTIONS: ± 1/64 DECIMALS: ±.01 ±.005 ANGLE: ±1/2°			DRAWING TITLE: WR90 WAVEGUIDE ISOLATOR		SHEET: N/A
PROPRIETARY NOTICE: THE INFORMATION IN THIS DRAWING IS PROPRIETARY AND SHALL NOT BE USED OR DISCLOSED WITHOUT WRITTEN PERMISSION FROM MICROWAVE COMMUNICATIONS LABORATORIES INC. (MCLI)		PART NO. ISW-4			
DRAWN: Paiboon Luexhamhan	DATE: 02-15-2011	CAGE CODE: OD2L5	SIZE: A	REV: N/A	DWG NO. 85523
APPROVED: T. Nguyen	DATE: 02-15-2011	DO NOT SCALE THE DRAWING			



THIRD ANGLE PROJECTION

