

REVISIONS				
ZONE	REV	DESCRIPTION	DATE	APPROVED

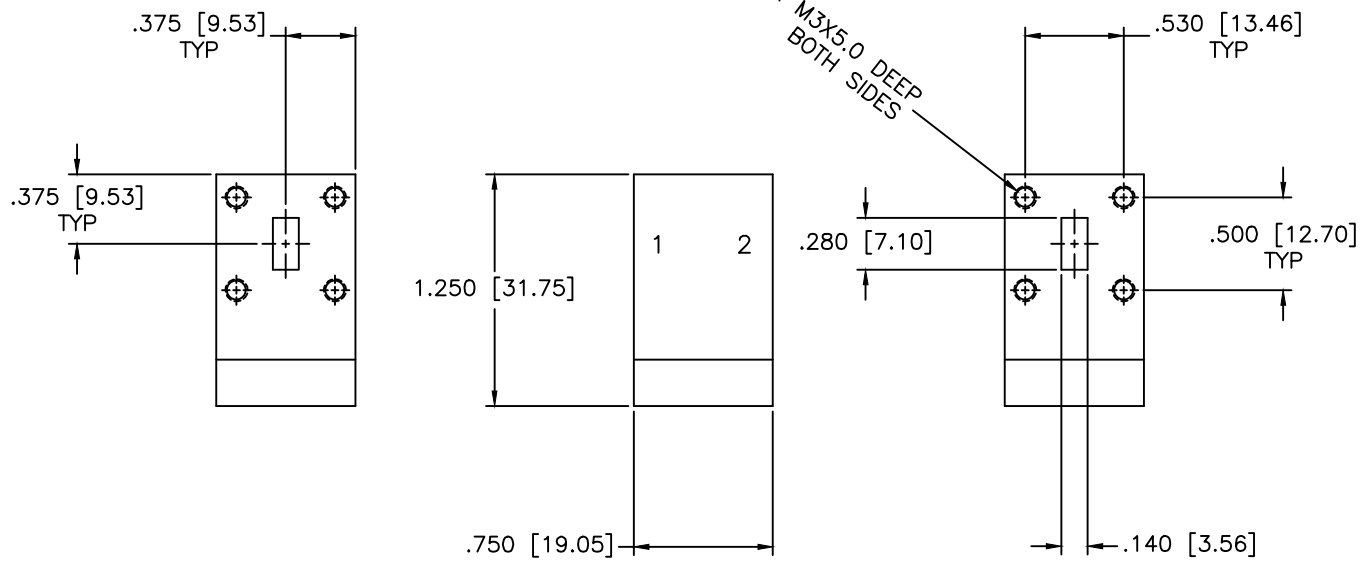

SPECIFICATIONS

FREQUENCY RANGE: 29.5–31.5 GHz
 EIA DESIGN (1 & 2): WR28
 VSWR: 1.35:1 Max.
 INSERTION LOSS: 0.40dB Max.
 ISOLATION: 20dB Min.
 POWER REVERSE: 2W
 POWER FORWARD: 10W
 POWER PEAK: 50W
 OPERATING TEMPERATURE: -40°C to +55°C

MATERIAL:			MICROWAVE COMMUNICATIONS LABORATORIES INC. 7255 30TH AVE. N. SAINT PETERSBURG, FL 33710 TEL: (727) 344-6254 FAX: (727) 381-6116 http://WWW.MCLI.COM		SCALE: N/A
					SHEET: N/A
		UNLESS OTHERWISE SPECIFIED: TOLERANCES IN (INCHES) OR [mm] (MILLIMETERS) FRACTIONS: ± 1/64 DECIMALS: ±.01 ±.005 ANGLE: ±1/2°	DRAWING TITLE: WR28 WAVEGUIDE ISOLATOR		
		PROPRIETARY NOTICE: THE INFORMATION IN THIS DRAWING IS PROPRIETARY AND SHALL NOT BE USED OR DISCLOSED WITHOUT WRITTEN PERMISSION FROM MICROWAVE COMMUNICATIONS LABORATORIES INC. (MCLI)	PART NO. ISW-30		
DRAWN: Paiboon Luexhamhan	DATE: 01-30-2012		CAGE CODE: OD2L5	SIZE: A	REV: N/A
APPROVED: T. Nguyen	DATE: 01-30-2012		DO NOT SCALE THE DRAWING		DWG NO. 85984