

REVISIONS				
ZONE	REV	DESCRIPTION	DATE	APPROVED

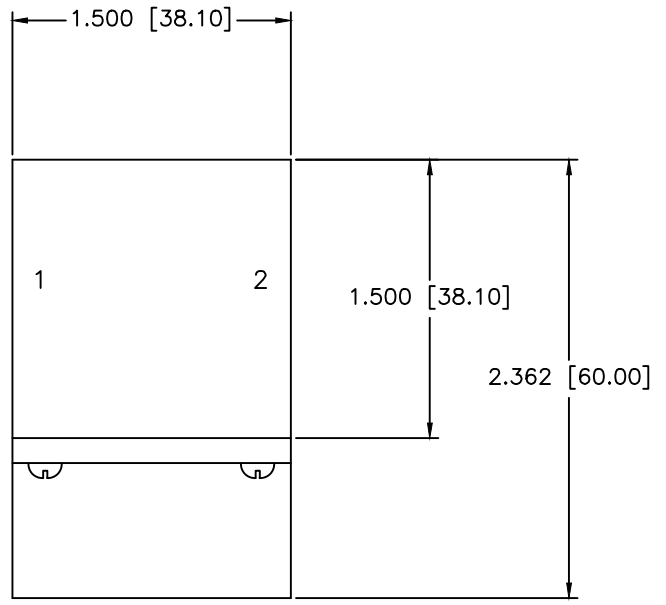
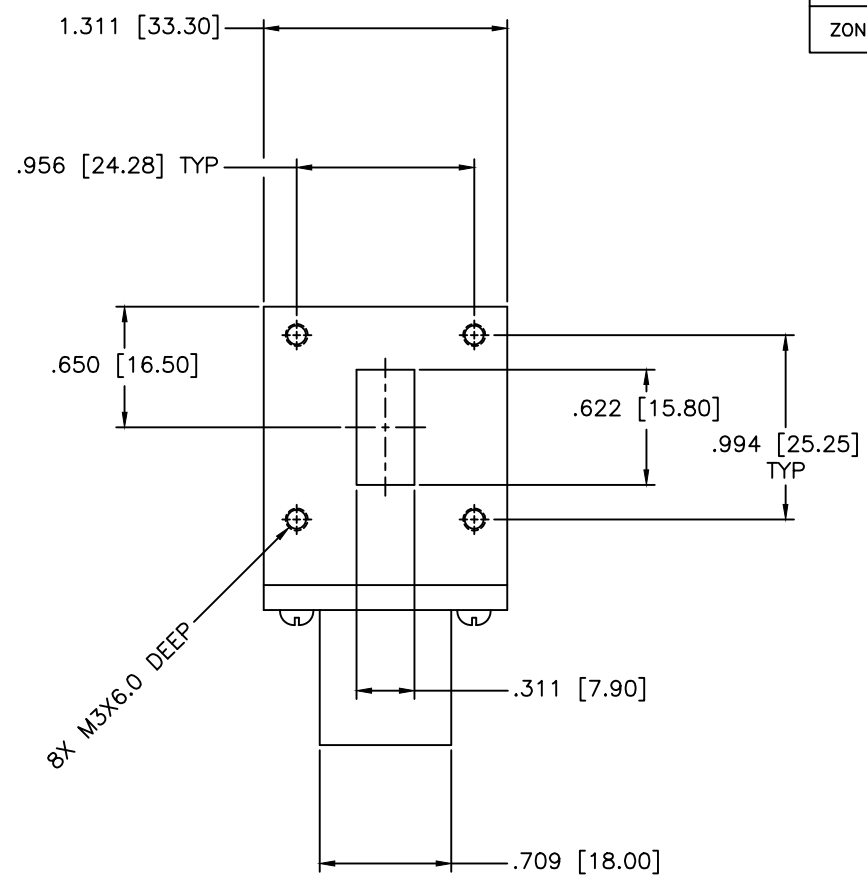

SPECIFICATIONS

FREQUENCY RANGE: 16-17 GHz
 EIA DESIGN (1-2): WR62
 VSWR: 1.20:1 Max.
 INSERTION LOSS: 0.30dB Max.
 ISOLATION: 21dB Max.
 POWER: 3W Average, 250W Peak
 OPERATING TEMPERATURE: -30°C to +70°C

MATERIAL:	
DRAWN: Paiboon Luekhamhan	DATE: 02-16-2011
APPROVED: T. Nguyen	DATE: 02-16-2011

	MICROWAVE COMMUNICATIONS LABORATORIES INC. 7255 30TH AVE. N. SAINT PETERSBURG, FL 33710 TEL: (727) 344-6254 FAX: (727) 381-6116 http://WWW.MCLI.COM		SCALE: N/A
	UNLESS OTHERWISE SPECIFIED: TOLERANCES IN (INCHES) OR [mm] (MILLIMETERS) FRACTIONS: ± 1/64 DECIMALS: ±.01 ±.005 ANGLE: ±1/2°		SHEET: N/A
DRAWING TITLE: WR62 WAVEGUIDE ISOLATOR		PART NO. ISW-14	
CAGE CODE: OD2L5	SIZE: A	REV: N/A	DWG NO. 85530
DO NOT SCALE THE DRAWING			

PROPRIETARY NOTICE:
 THE INFORMATION IN THIS DRAWING IS PROPRIETARY
 AND SHALL NOT BE USED OR DISCLOSED WITHOUT WRITTEN
 PERMISSION FROM MICROWAVE COMMUNICATIONS
 LABORATORIES INC. (MCLI)

THIRD ANGLE PROJECTION