

HOLE OPTION

- 4-40UNC-2B .170 DEEP
- 6-32UNC-2B THROUGH HOLE
- 8-32UNC-2B THROUGH HOLE
- Ø.165 THROUGH HOLE

8X M3 THRU HOLES OPTION

4X R.118 [R3.00]  
BOTH SIDES

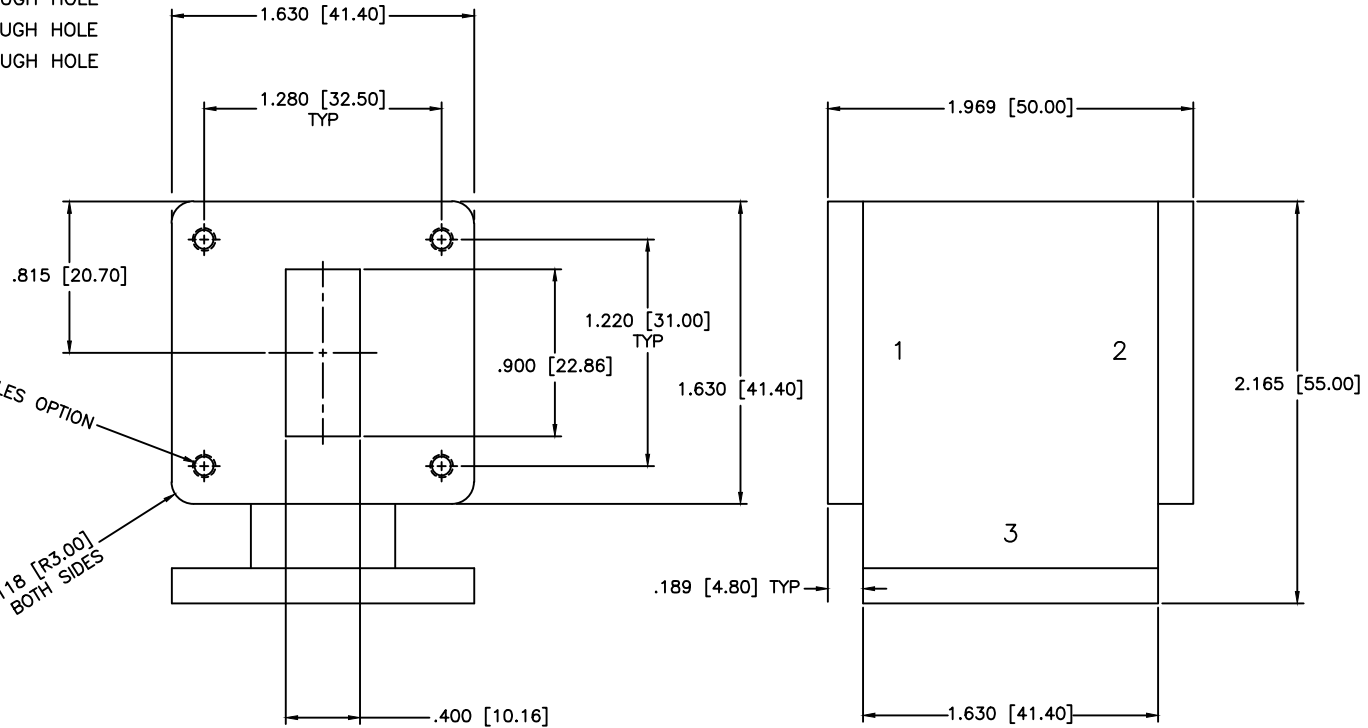

REVISIONS

ZONE	REV	DESCRIPTION	DATE	APPROVED
------	-----	-------------	------	----------

SPECIFICATIONS

- FREQUENCY RANGE: 9-10 GHz
- EIA DESIGN (1,2,3): WR90
- VSWR: 1.18:1 Max.
- INSERTION LOSS: 0.20dB Max.
- ISOLATION: 22dB Min.
- POWER: 200W Avg, 500W Peak
- OPERATING TEMPERATURE: -30°C to +70°C

MATERIAL:		<b>MCLI</b>	MICROWAVE COMMUNICATIONS LABORATORIES INC. 7255 30TH AVE. N. SAINT PETERSBURG, FL 33710 TEL: (727) 344-6254 FAX: (727) 381-6116 http://WWW.MCLI.COM		SCALE: N/A
			UNLESS OTHERWISE SPECIFIED: TOLERANCES IN (INCHES) OR [mm] (MILLIMETERS) FRACTIONS: ± 1/64 DECIMALS: ±.01 ±.005 ANGLE: ±1/2°		SHEET: N/A
DRAWN: Paiboon Luekhamhan		DATE: 02-15-2011		DRAWING TITLE: WR90 WAVEGUIDE CIRCULATOR	
APPROVED: T. Nguyen		DATE: 02-15-2011		PART NO. CSW-4	
		CAGE CODE: OD2L5		SIZE: A	REV: N/A
		DWG NO. 85527		DO NOT SCALE THE DRAWING	

PROPRIETARY NOTICE:  
THE INFORMATION IN THIS DRAWING IS PROPRIETARY  
AND SHALL NOT BE USED OR DISCLOSED WITHOUT WRITTEN  
PERMISSION FROM MICROWAVE COMMUNICATIONS  
LABORATORIES INC. (MCLI)

THIRD ANGLE PROJECTION